

SOMETHING
EXTRAORDINARY



JCS CAPITAL CAMPAIGN

NOW TO HIM WHO IS ABLE TO DO
IMMEASURABLY MORE
THAN ALL WE ASK OR IMAGINE...
TO HIM BE GLORY...

Forever and Ever!

AMEN.

EPHESIANS 3:20-21

Since opening its doors in September 1930 in the basement of a church with 31 students, Jenison Christian School has partnered with thousands of families to provide a Christ-centered education, preparing them for a life of service in Christ's Kingdom.

Today, JCS has over 500 students in preschool through eighth grade, an increase from 380 just 4 short years ago. Our need for space has been met with consolidating our childcare program to 2 large classrooms, utilizing open STEM and community rooms, and coming this summer - building a NEW classroom! We are grateful to our community's response to providing Christ-centered education for generations to come in Jenison and surrounding communities!

JENISON CHRISTIAN SCHOOL MASTER PLAN

After 5 summers of DEBT FREE construction including updating all our 1960's classrooms, providing space for our growing student body, and creating a safe traffic flow and entrance near our Preschool wing, we have one last BIG NEED for Jenison Christian School in our 2019 Master Plan - Safety for the entire campus!

The need for safety has 3 large pieces: a new, double door vestibule main entrance (office), a new, double door vestibule entrance near the middle school, and a redesigned Bus loop and staff/visitor parking. The cost for these 3 projects total \$2.5 Million. Meeting this great need will bring the entire campus of Jenison Christian School in line with best safety practices, and complete the 2019 Master Plan designed to keep JCS thriving in the 21st century.

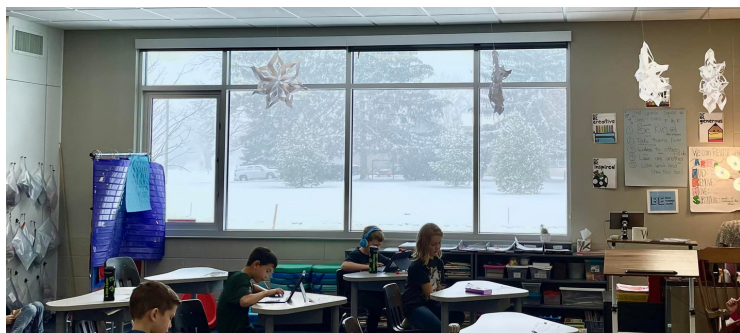

SAFETY PLAN FOR JCS

- A double door entry vestibule for the main office entrance. Not only will this create a SAFE and SECURE main entrance, but also provide greater energy efficiency for the school.
- The main office will also be updated to include a door off the entrance vestibule, so all visitors during the school day will have to pass through the office before entering the school.
- Our buses pass through the exit of the parent drop off loop when entering the staff/visitor parking lot at JCS. A redesigned bus loop and parking lot will create a separate flow of traffic for buses, parking, and parents coming out of the car drop off. This parking lot model will be a great enhancement to the safety of our students walking to buses and cars!
- A new double door entry vestibule into the middle school, connecting our middle school to the upper elementary hallway. While this entrance would remain locked throughout the school day, connecting the building will provide great safety for our staff and students who pass through the current open outside space. The double door vestibule is line with best practices for school safety.

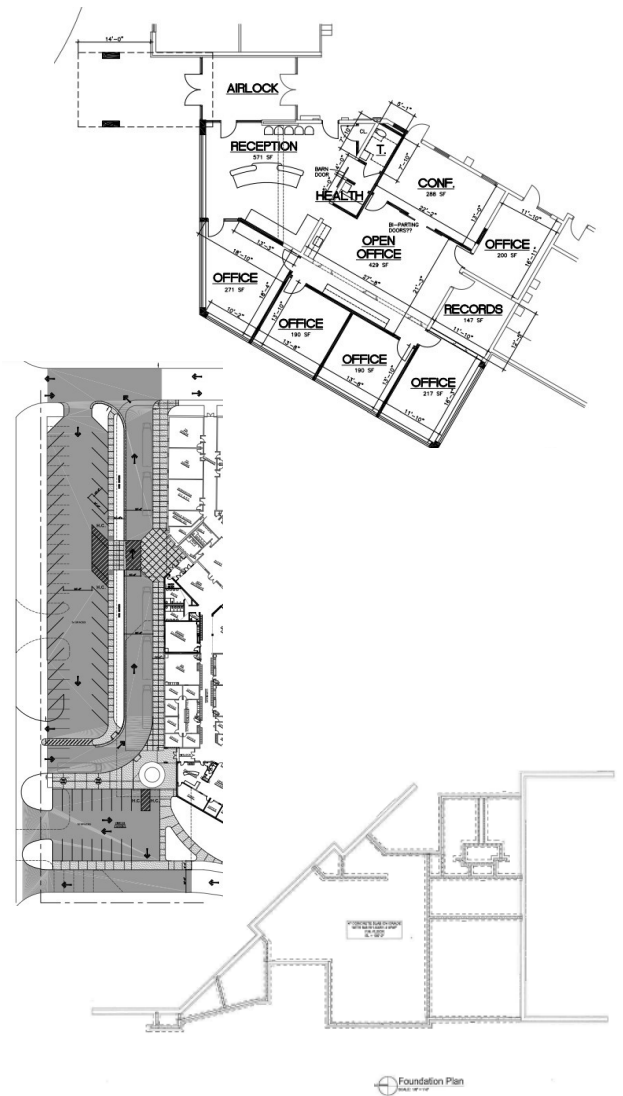

HOW YOU CAN HELP IN GOD'S EXTRAORDINARY STORY AT JCS

JCS is seeking financial support from our greater community as we continue to welcome new students and families each year. Your tax deductible gift will allow kids to KNOW CHRIST at Jenison Christian School. The need to make all of JCS a SAFE and SECURE campus is \$2.5 Million.

Please consider partnering with us in the mission of Jenison Christian School - to embrace our community with the love of Christ, foster academic growth that is immersed in Christ, and empower God's children for a life of service in His kingdom.

For more information, contact Liz Wiersema at lwiersema@jenisonchristian.org or 616-457-3301.